

1 April 27, 1979

Introduced by: ROBERT B. DUNN
Proposed Ordinance No.: 78-1101

2
3
4
5
6
7
8 ORDINANCE NO. 4238

9 AN ORDINANCE amending King County Zoning Resolution
10 No. 25789, as amended, by amending the Zoning Map
11 thereof reclassifying certain property thereon at
the request of Mt. Baldy Land Company, Building and
Land Development Division File No. 427-78-R.

12 BE IT ORDAINED BY THE COUNCIL OF KING COUNTY:

13 SECTION 1. Mt. Baldy Land Company petitioned on September 11,
14 1978, that the property described in Section 3 below be reclassi-
15 fied from FR to SE and this application was assigned Building and
16 Land Development Division File No. 427-78-R.

17 SECTION 2. The report and recommendation of the Building and
18 Land Development Division was transmitted to the Zoning and Sub-
19 division Examiner on November 23, 1978, and hearing was held by the
20 Examiner on November 30, 1978. The report of the Examiner was
21 filed with the Clerk of the King County Council on December 22,
22 1978, and the Council approved the reclassification by Motion No.
23 03926 on January 2, 1979.

24 SECTION 3. The legal description of the property to be re-
25 classified is attached as Appendix A and is hereby made a part of
26 this ordinance. The above described property is shown on the
27 attached map which is designated Appendix B and is hereby made a
28 part of this ordinance.

29 SECTION 4. The King County Council does hereby amend King
30 County Zoning Code, Resolution No. 25789, as amended, by reclassi-

1 fying that property described and shown in Section 3, Appendices
2 A and B above, to SE and directs that Area Map E 31-20-7 be modi-
3 fied to so designate.

4 INTRODUCED AND READ for the first time this 30th
5 day of October, 19 78.

6 PASSED this 7th day of May, 19 79.

7 KING COUNTY COUNCIL
8 KING COUNTY, WASHINGTON

9 Ruby Chow
10 Chairman

11 ATTEST:
12 Joan M. Owens DEPUTY
13 Clerk of the Council

14 APPROVED this _____ day of _____,

18 KING COUNTY EXECUTIVE
19 DEEMED ENACTED WITHOUT
20 COUNTY EXECUTIVE'S SIGNATURE
21 DATED: May 17, 1979

FILE NO. 427-78-R

APPENDIX A

OVERALL LEGAL DESCRIPTION:

The Northeast Quarter of the Northeast Quarter of Section 31,
Township 20 North, Range 7 East, W.M. Less County roads.

Applicant: MT. BALDY LAND CO.
Zone Change: F-R to S-E
STR: E 31-20-7

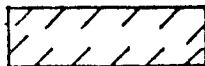
 Proposed
Reclassification



0' 132 0'

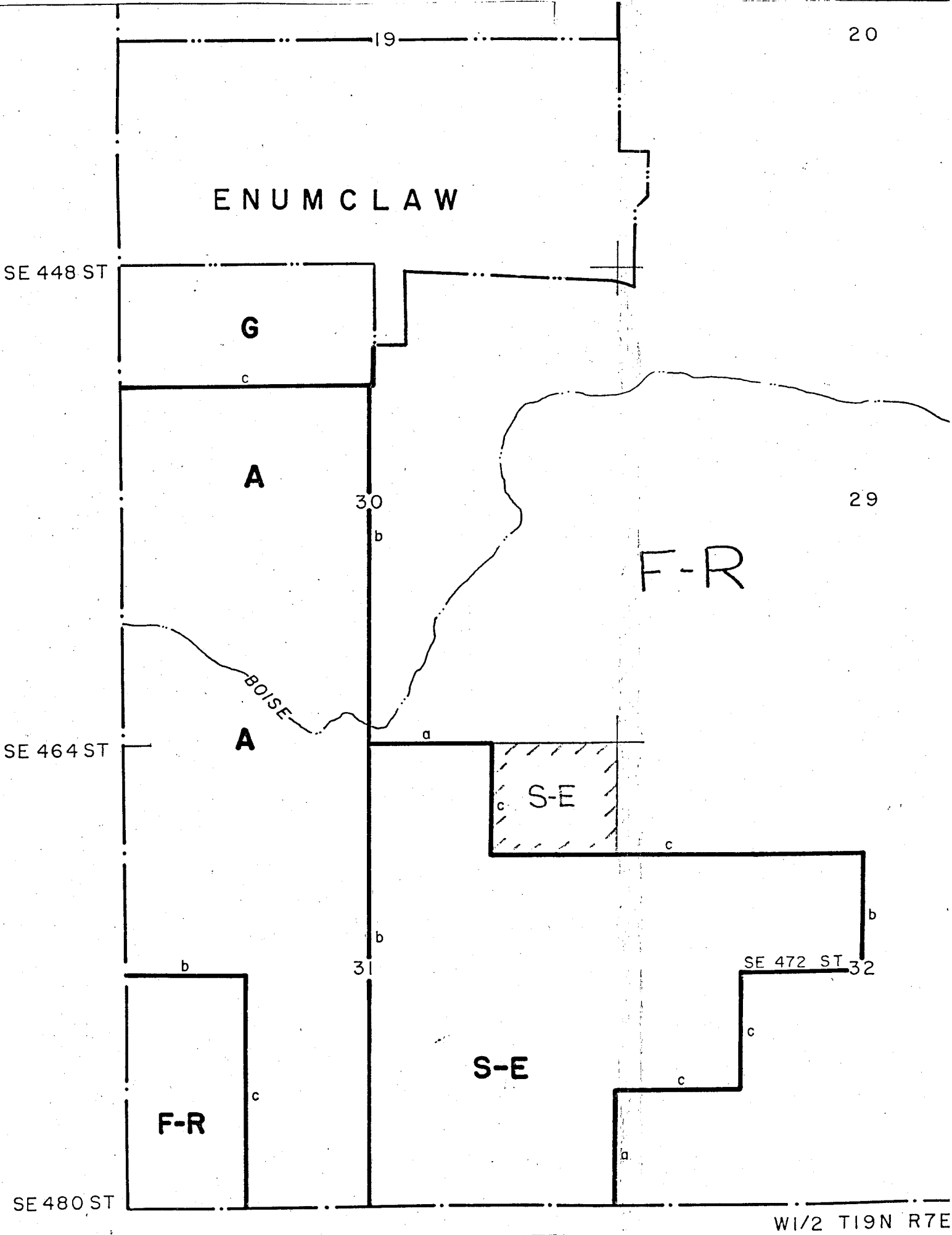

W1/2 T19N R7E